

# Prolam PLX20™

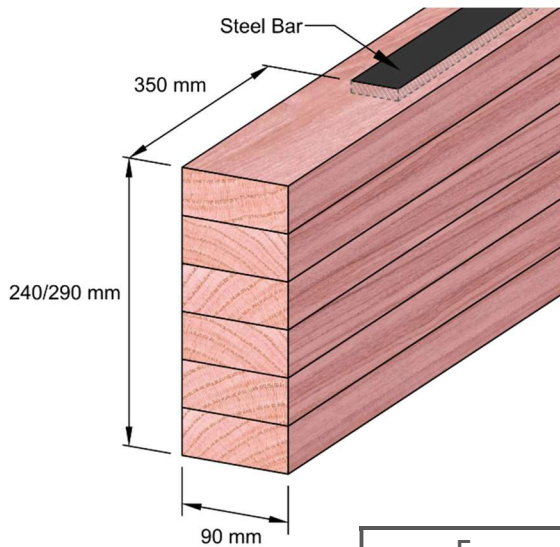

**Prolam®**  
Engineered Laminated Timber



The Prolam PLX20 is an innovative structural laminated beam being the ideal choice for garage door lintels. Manufactured from radiata pine, with steel inserts in the top and bottom laminates, PLX20's have superior spanning capabilities.

It is the responsibility of the designer to establish hold down fixing's accordance with NZS3604:2012 or an alternative fixing.

	E Lower bound Modulus of Elasticity GPa	f <sub>b</sub> Bending MPa	f <sub>s</sub> Shear MPa	f <sub>c</sub> Compression parallel to grain MPa	f <sub>t</sub> Tension MPa	G Modulus of Rigidity MPa
PLX20-250100	20	40	3.7	18	4	480
PLX20-300100	21	45	3.7	18	4	480

## Product Details

Code	Size
PLX20-250100	240x90
PLX20-300100	290x90

Lengths: 3.6m, 4.2m, 4.8m, 5.4m, 6.0m

Treatment: H1.2

Grade: Non-Visual

Applications: Lintels and Rafters

## Key Features and Benefits

- Light weight
- Labour Savings – quicker to install
- Span further with smaller member
- Competitively priced
- Easy to Specify using Prolam Specifier [specifier.prolamnz.com](http://specifier.prolamnz.com)

*Note: PLX20 have been signed off by Tasman Consulting engineers and independently tested by Scion Research in Rotorua.*

For further information and technical support please contact our team on

03 526 7436 or [info@prowoodnz.com](mailto:info@prowoodnz.com)