

June 2021



Prolam[®]
Engineered Laminated Timber

Newsletter

In this Newsletter:

WELCOME TO OUR JUNE 2021 ISSUE

- 1 Message from the Director
CASE STUDY:
Tahunanui Toilet Block
- 2 PRODUCT FOCUS:
New PLX20[®]
The story behind PLX20[®]
Legacy Specifier Notification
- 3 BEHIND OUR BRAND:
New Sawmill
Welcome Zubin Karami
FAQ Video Series
Discontinued Lines



Dear Customers,

We would like to thank you for your patience as the construction industry faces many unprecedented challenges. Almost everyone involved in the construction industry has been affected by disruptions of raw materials and timber supply. The shortage of timber and glue has forced us to extend leadtimes. The team is constantly working on solving these issues and reducing leadtimes. To help increase our supply of Prolam, we have set up a small sawmill this year. With this, we are securing the source of our timber, ensuring our customers have what they need. Progress will be made in increasing our kiln drying capacity, which we hope to accomplish within six months. We are looking forward to the installation of our new finger jointer, which we hope to have operational in two weeks. Our production capacity will be greatly increased as a result of these two projects, and lead times will hopefully be reduced.

I would like to thank all our customers for supporting us in these unusual times.

Kind Regards

John Woodman | Managing Director

CASE STUDY: Tahunanui Toilet Block

A new toilet block has been completed at Tahunanui, a project designed by JTB architects and built by Comans. Together, Prolam and Konstructz made sure that all beams and posts were cut at the perfect lengths to ensure easy installation. Nelson Mayor Rachel Reese says the upgraded toilets will make life easier for the thousands of Nelsonians and visitors that use Tahunanui Beach Reserve each year. Prolam was pleased to be involved in this local project using sustainable products to reduce the Carbon footprint.

Products Used:

180x180 PL8 H5 Posts

290x88 PL8 H3.2 Beams



PRODUCT FOCUS: NEW PLX20® beams

The NEW Prolam PLX20 is an innovative structural laminated beam being the ideal choice for garage door lintels.

Manufactured from radiata pine, with steel inserts in the top and bottom laminates, PLX20's have superior spanning capabilities.

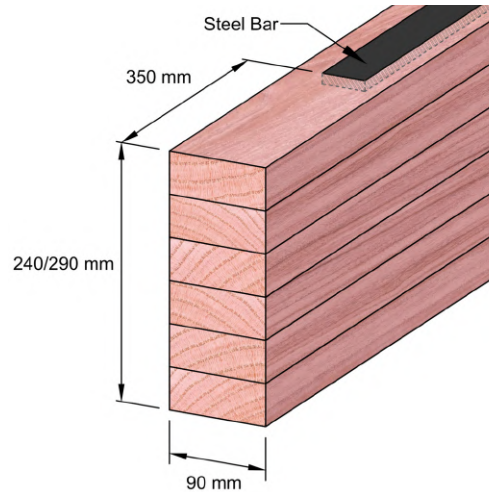

Key Features and Benefits

- Light weight
- Labour Savings – quicker to install
- Span further with smaller member
- Competitively priced
- Easy to Specify using Prolam Specifier specifier.prolamnz.com

Product Details

Code and Size

PLX20-250100 | 240x90x5.4

PLX20-300100 | 290x90x5.4

Treatment: H1.2

Grade: Non-Visual

Applications: Lintels and Rafters



The story behind PLX20® beams

We launched a brand new innovative product, the PLX20 beam, to meet the sudden gap in high strength structural timber caused by discontinuation of the PL17 range.

Like all great innovations, it started as an idea. Research and investigation were conducted by our local engineers, and our technical team determined that it was entirely feasible.

It wasn't long before the first batch of PLX20 beams were produced.

They were sent to a licensed research and development facility for professional strength testing.

They were a huge success and well exceeded our expectations.

Following successful experiments with several batches, we were ready to sell.

Now we are frequently manufacturing.

Check out the photos and diagrams of the testing.

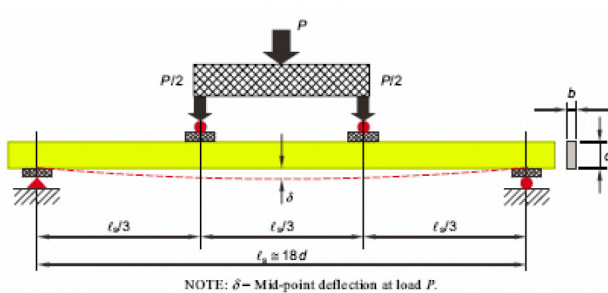

Diagram showing how the PLX20s were tested



PLX20 placed in the testing machine prior to testing.

For further information and technical support, please contact our team on:

03 526 7436 or info@prowoodnz.com

IMPORTANT LEGACY SPECIFIER NOTIFICATION

This is a reminder that our Legacy Specifier will be made inactive from the 30th June.

Please make sure you have downloaded any saved work as this will not be accessible from this date onwards.

[Click Here to access our new Specifier](#)

BEHIND OUR BRAND: New Sawmill

In recent months as timber supply has become significantly scarcer, setting up our own sawmill was a step in the direction of being more self-sufficient. Being operational now for 3 months we are seeing the benefits by custom cutting to our preferred laminating sizes, increased laminating efficiency and higher volume of feedstock for our laminating lines. As we scale up the sawmill operation, we endeavour to reduce lead times and better serve all our valued customers.



BEHIND OUR BRAND: Meet Zubin Karami



Zubin recently joined our team this year as a structural engineer. His role involves research and development of new products such as PLX20 and providing technical support to customers. He also creates updated product information and designs supplementing structural solutions for our team and our customers. Zubin enjoys assisting customers with their projects and receiving positive feedback as a result. He appreciates the positive working environment and our supportive team. In his spare time, Zubin enjoys the great outdoors, doing DIY projects around home and much more.

FAQ VIDEO SERIES

Click [HERE](#) to check out our FAQ Video series on our YouTube channel. Let us know if you have a question we can answer.



Prolam Post vs Solid



PL8 & PL12 Difference



Prolam Lintel vs SG8 Lintel

DISCONTINUED LINES

Please note we have discontinued the following product lines:

Projoist range with Rimboard

H3.2 Posts

Non-Visual Posts

Formwork range with Brick Cavity

PL17 Posts and Beams

Fence Capping

We love hearing from you. If you have any suggestions please email us on info@prowoodnz.com.